

The duty to manage asbestos is a legal requirement. Dutyholders must protect people from the risks of exposure to asbestos, including people who work in/on or visit their buildings.

Use the links below to find out more about the duty to manage:

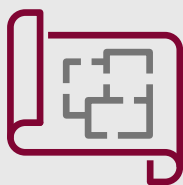

Duty to manage asbestos in buildings

What the dutyholder must do, including identifying asbestos, assessing risk and making a plan.



Asbestos register template

Template of an asbestos register – a live document which must always contain current information on the presence and condition of asbestos-containing materials, known as ACMs, in your building.



Asbestos management plan template

Template of an asbestos management plan which sets out the procedures and arrangements to manage the risk from asbestos-containing materials in your buildings.



Examples of how asbestos risks can be managed

Examples of asbestos management in practice.



HSE Asbestos newsletter

Sign up to the HSE asbestos newsletter for free health and safety news and updates on this topic.